

1 TREE INSTALLATION

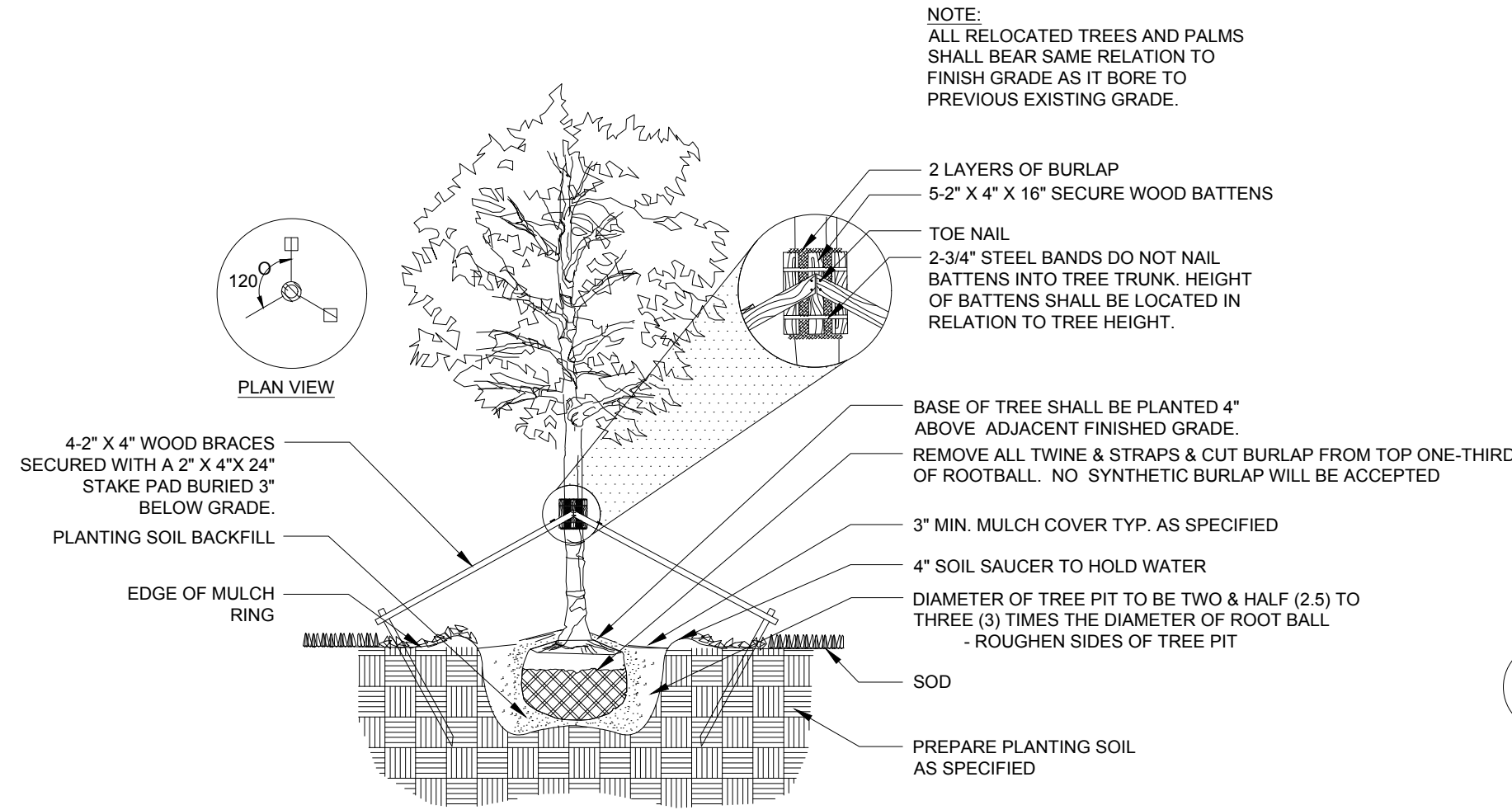

2 PALM INSTALLATION

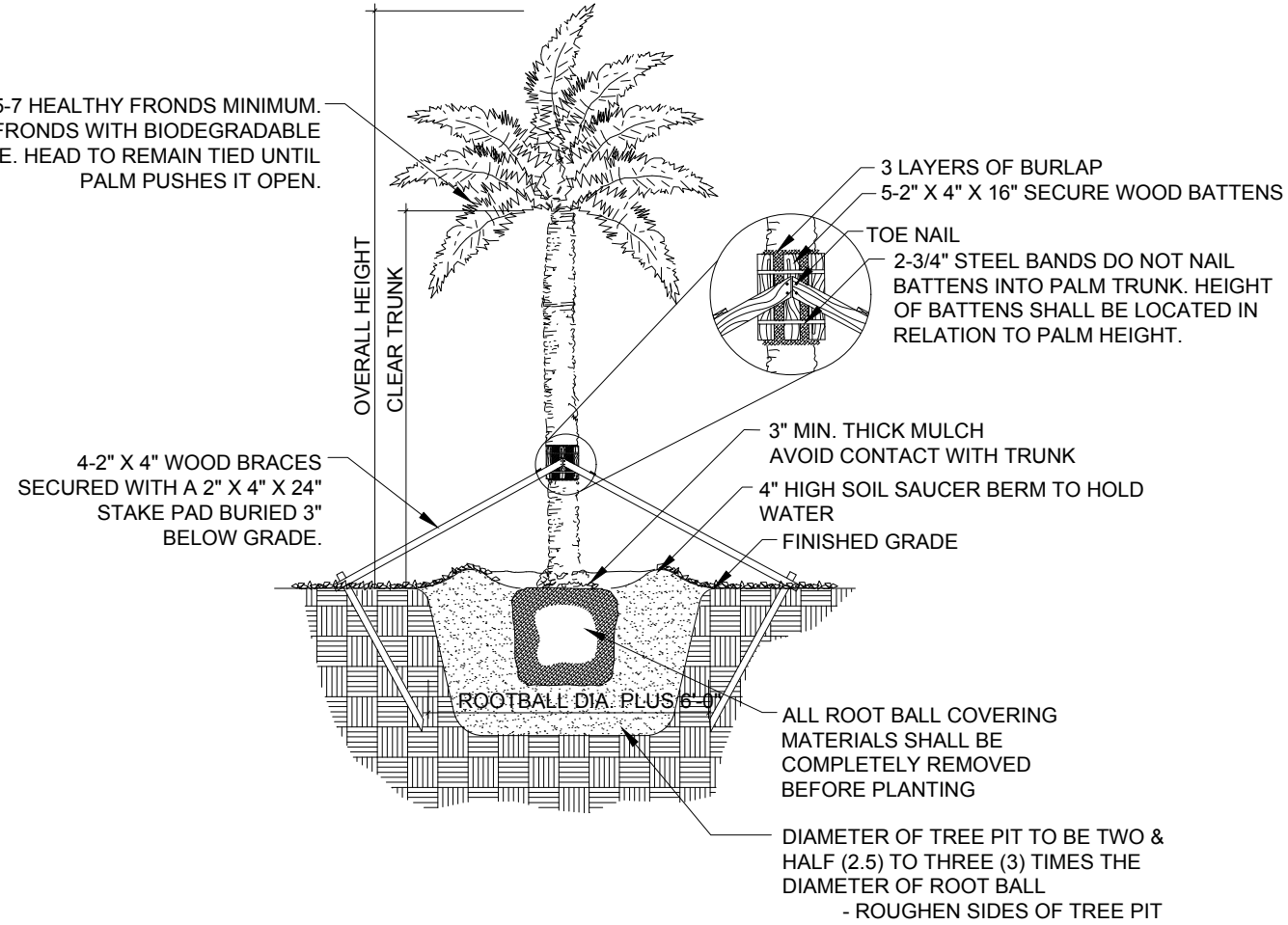

3 SMALL TREE

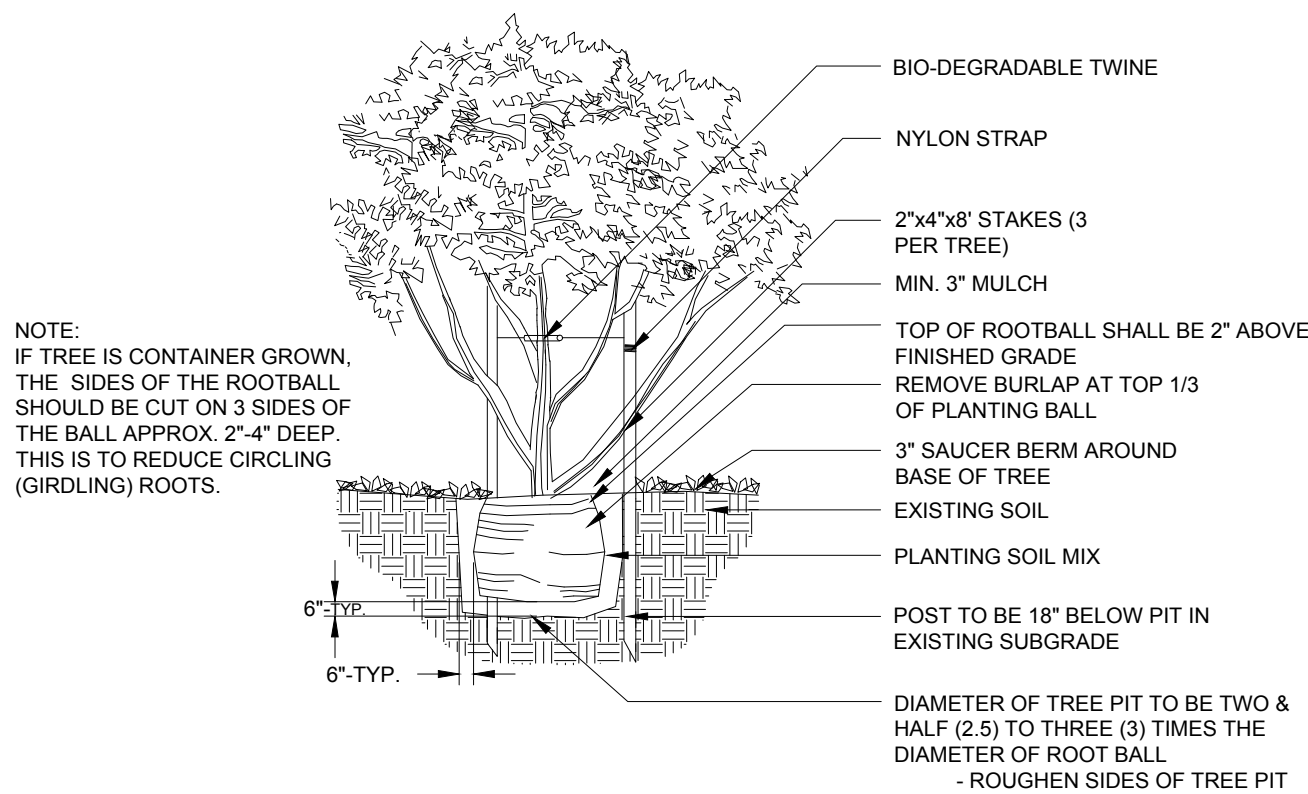

4 SHRUB PLANTING

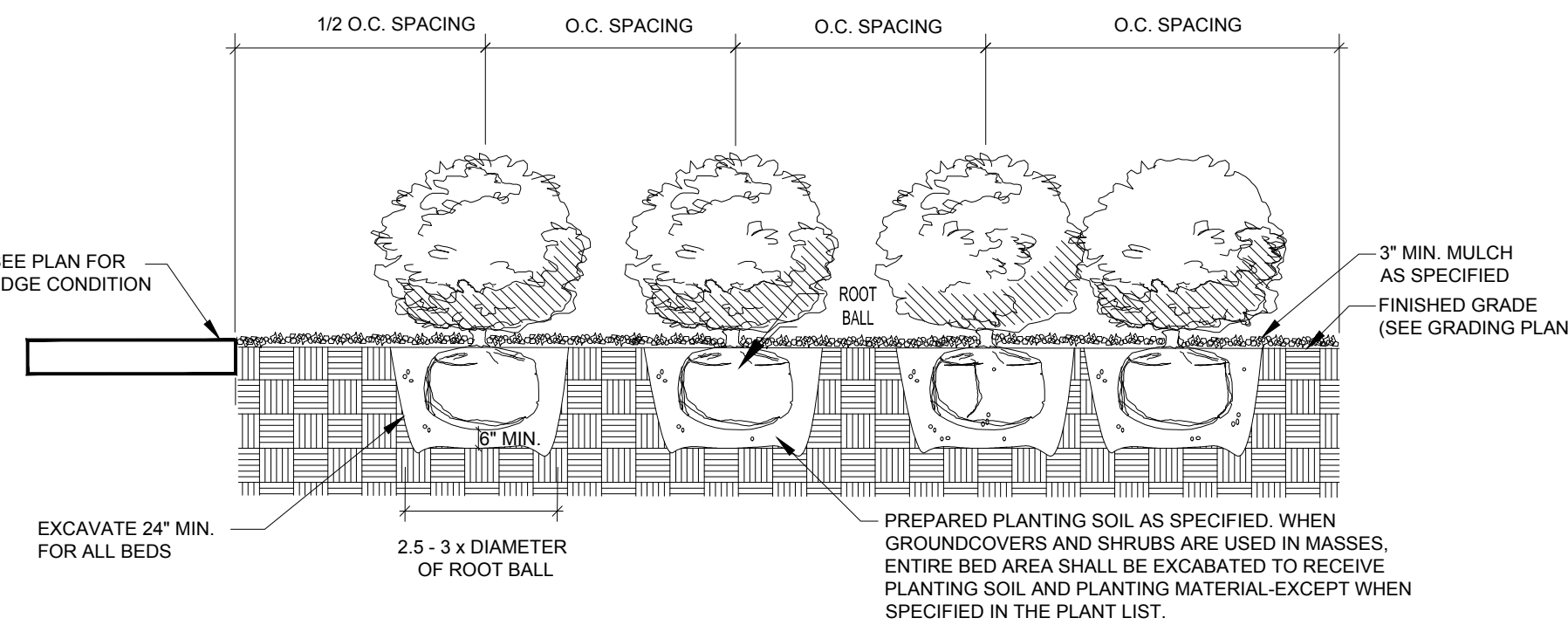

5 GROUNDCOVER PLANTING

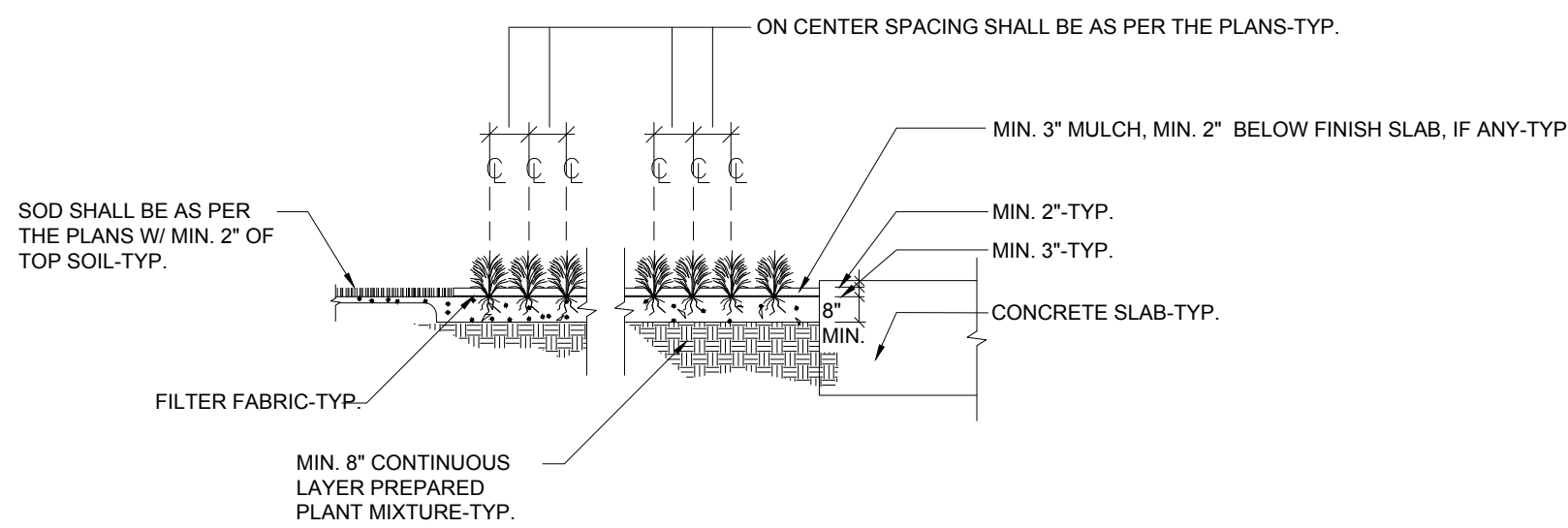

6 PLANTING ADJACENT TO BUILDING

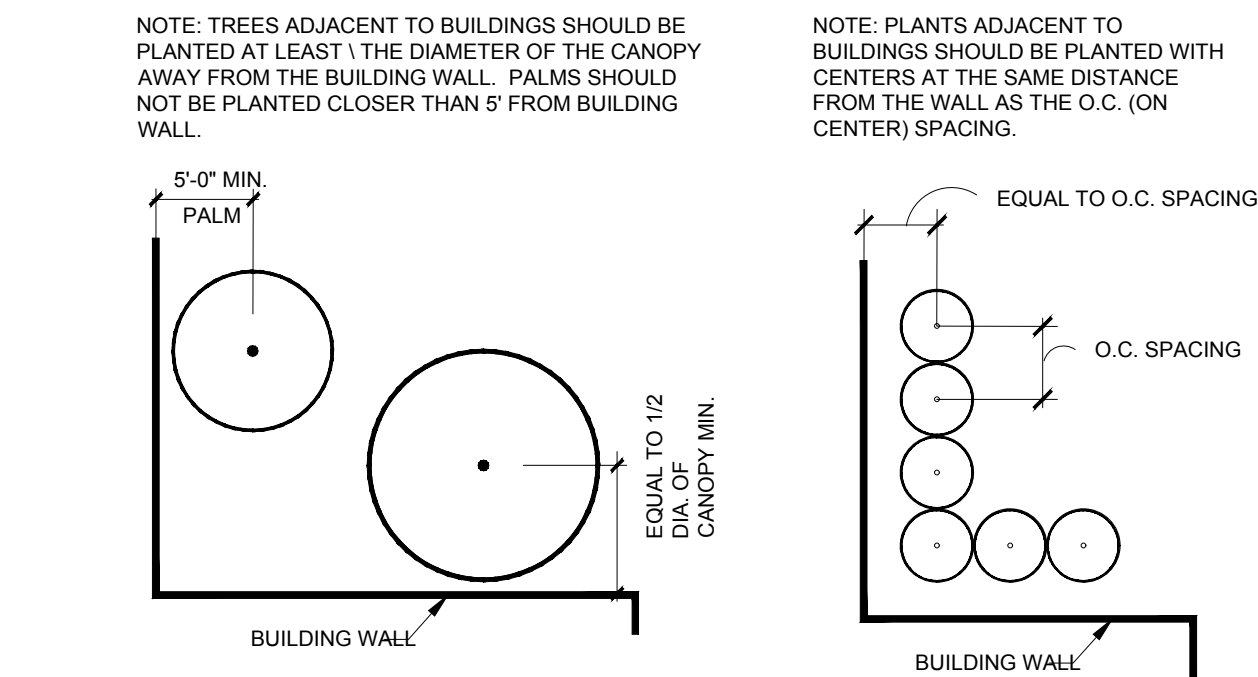

7 SOD INSTALLATION

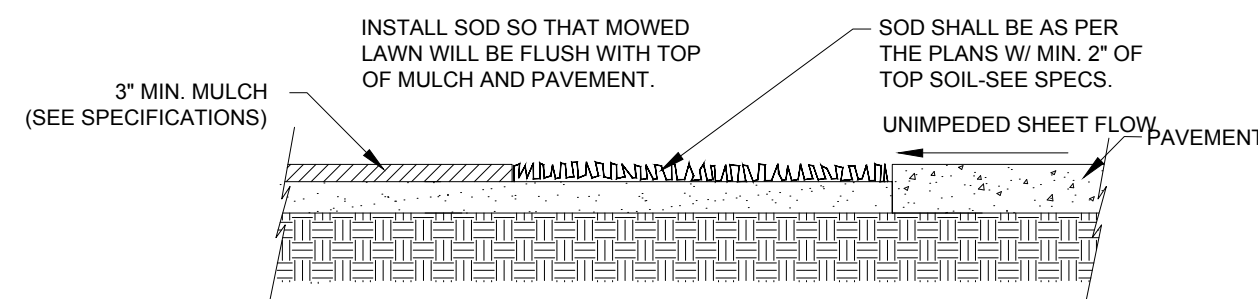

8 ROOT BARRIER

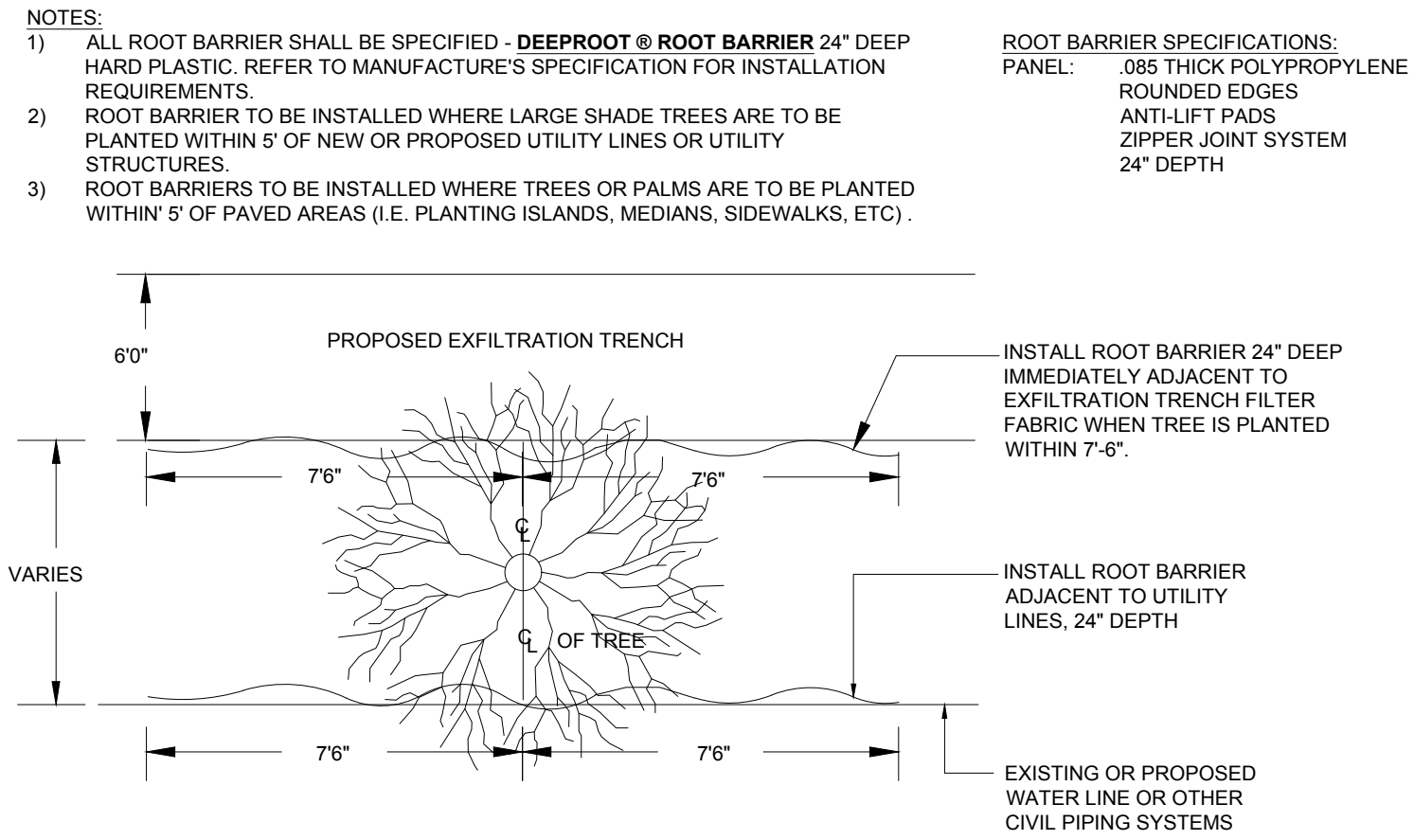

9 MECHANICAL EQUIPMENT SCREENING

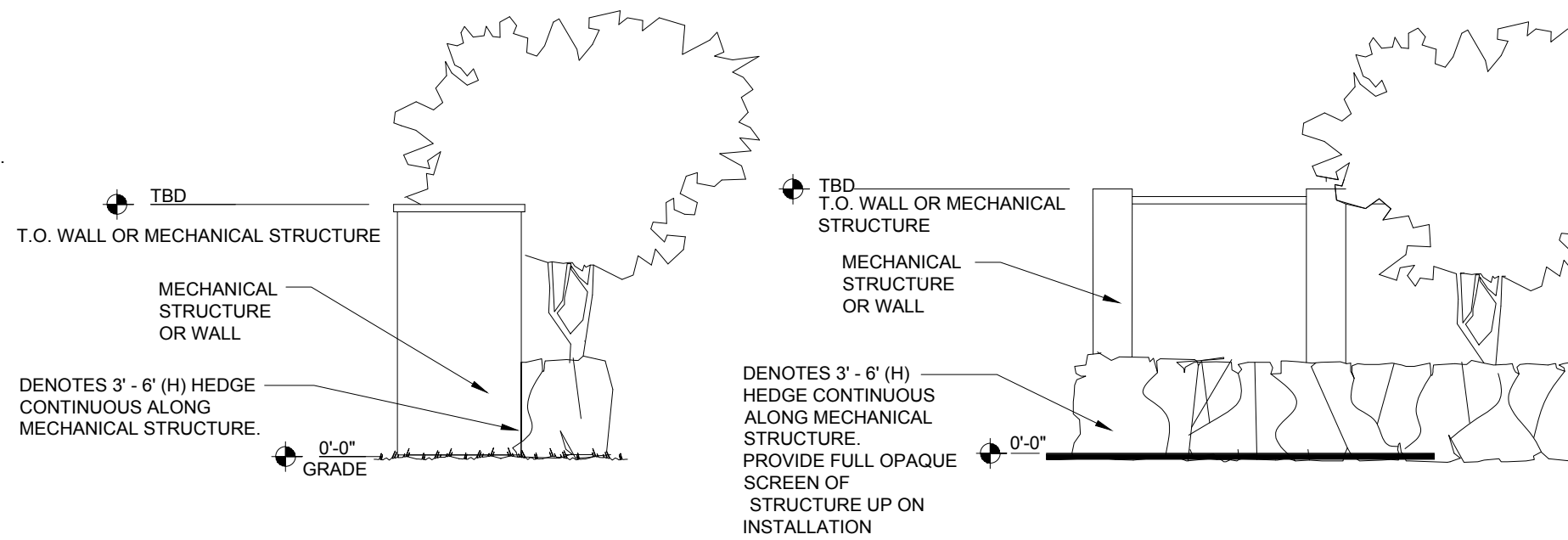

10 ADDAPAVE TREE PIT SYSTEM

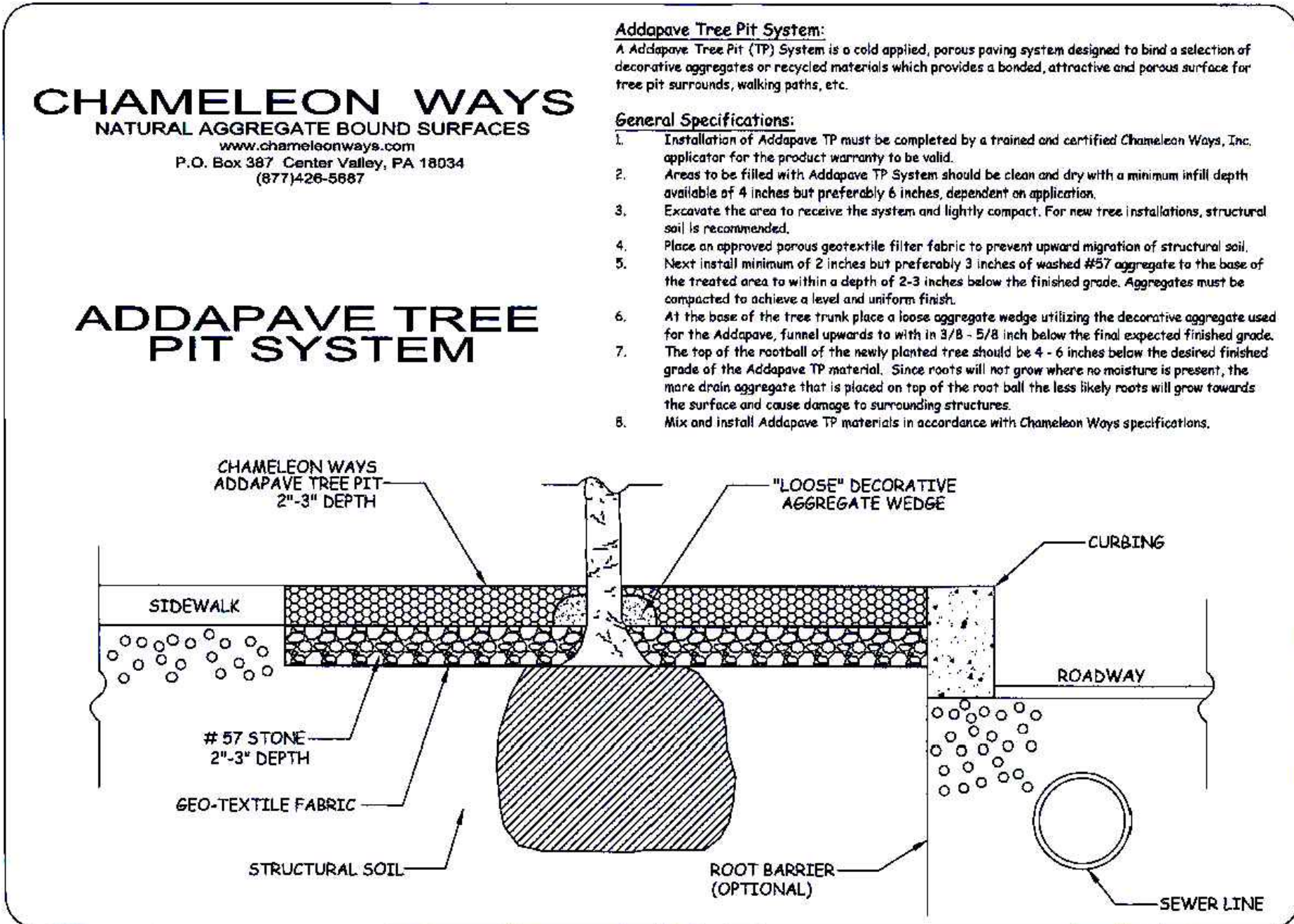

REVISIONS

REV	DATE	COMMENT	DRAWN BY

Sunshine811
Call 811 or visit sunshine811.com two full business days before digging to have buried facilities located and marked.
Check positive response codes before you dig!

ISSUED FOR MUNICIPAL & AGENCY REVIEW & APPROVAL

THIS DRAWING IS INTENDED FOR MUNICIPAL AND/OR AGENCY REVIEW AND APPROVAL. IT IS NOT INTENDED AS A CONSTRUCTION DOCUMENT UNLESS INDICATED OTHERWISE.
PROJECT No.: FLB240130-00-0A
DRAWN BY: GD
CHECKED BY: BW
DATE: 09/11/2024
CAD ID: P-CIVIL-LAND

PROPOSED SITE PLAN DOCUMENTS FOR POMPANO PICKLE, LLC

PROPOSED DEVELOPMENT
210-217 NE 3RD STREET
POMPANO BEACH, FL
BROWARD COUNTY

THIS ITEM HAS BEEN DIGITALLY SIGNED AND SEALED BY BRETT MICHAEL WALDMAN, P.E., ON THE DATE ADJACENT TO THE SEAL. PRINTED COPIES OF THIS DOCUMENT ARE NOT CONSIDERED SIGNED AND SEALED AND THE SIGNATURE MUST BE VERIFIED ON ANY ELECTRONIC COPIES.

SHEET TITLE:

LANDSCAPE DETAILS

SHEET NUMBER:
L-704

ORG. DATE - 09/11/2024